

DISTRIKT BED

M165



DISTRICT EIGHT

CARE INSTRUCTIONS

This piece of furniture is made from solid wood and metal. Over time it will develop a natural red-orange patina on top of the metal parts, which is desired. It is recommended to re-wax all parts at least once a year to prevent the acceleration of the patina process.

The wooden parts can be cleaned with pledge or any other wax-based furniture polish. To re-wax this furniture, apply a thin even layer of furniture paste wax on to the surface using a soft lint free cloth or rag.

SUPPLIED COMPONENTS

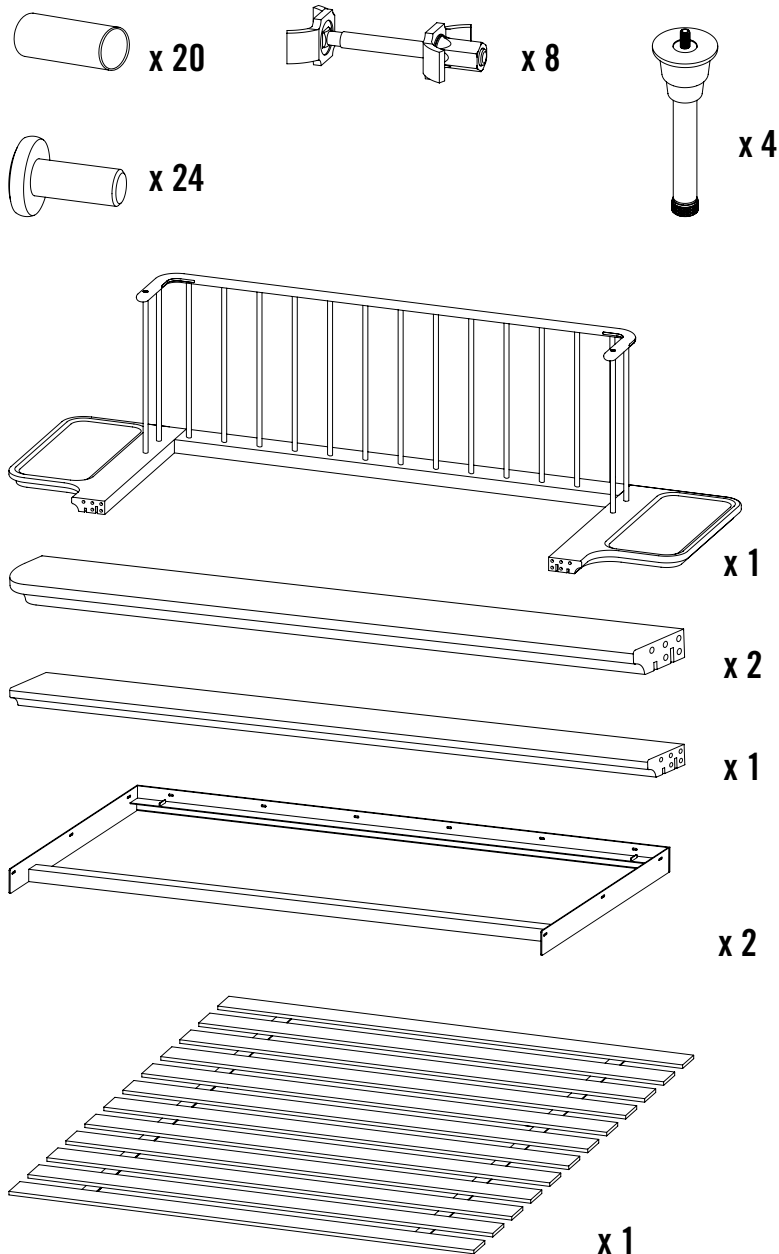

TOOLS NEEDED

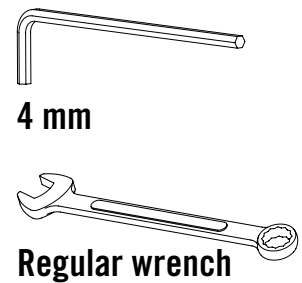

RECOMMENDED TOOLS

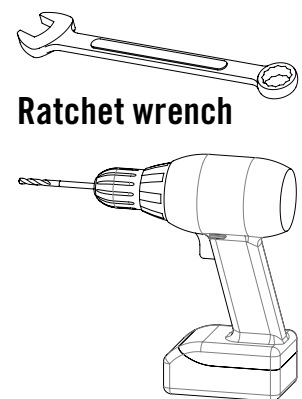

ASSEMBLY STEPS

1 —  x 10

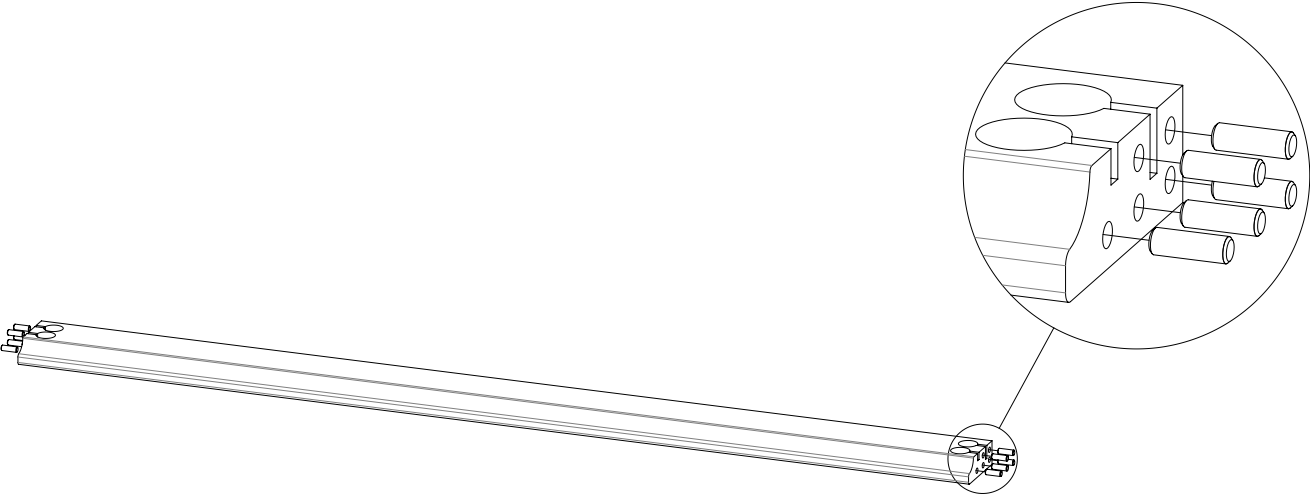

2 —  x 10  x 4

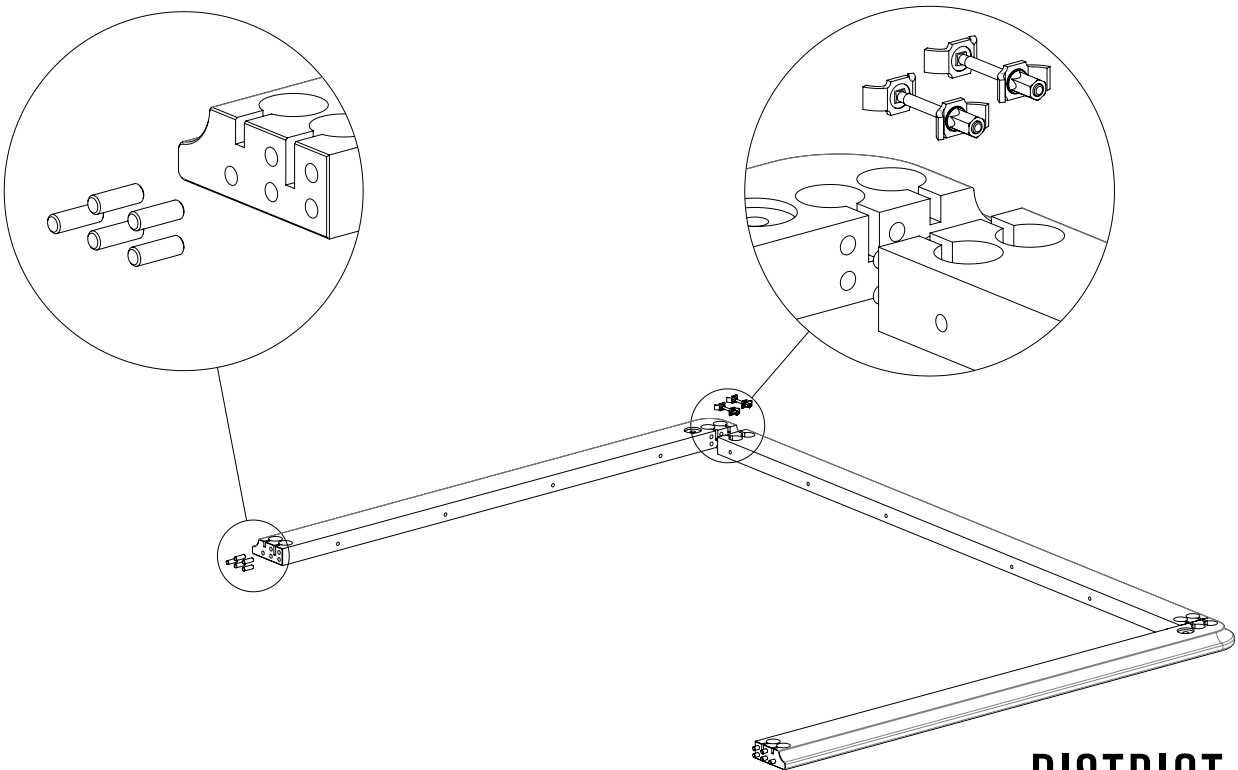

ASSEMBLY STEPS

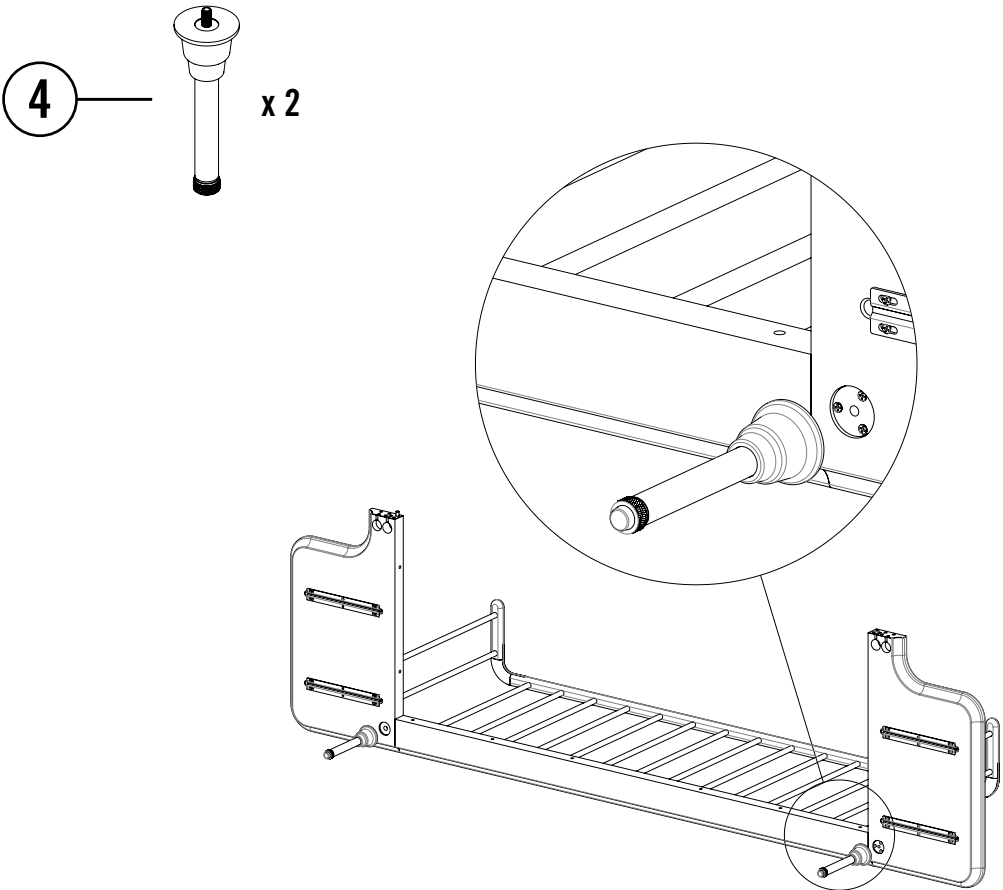
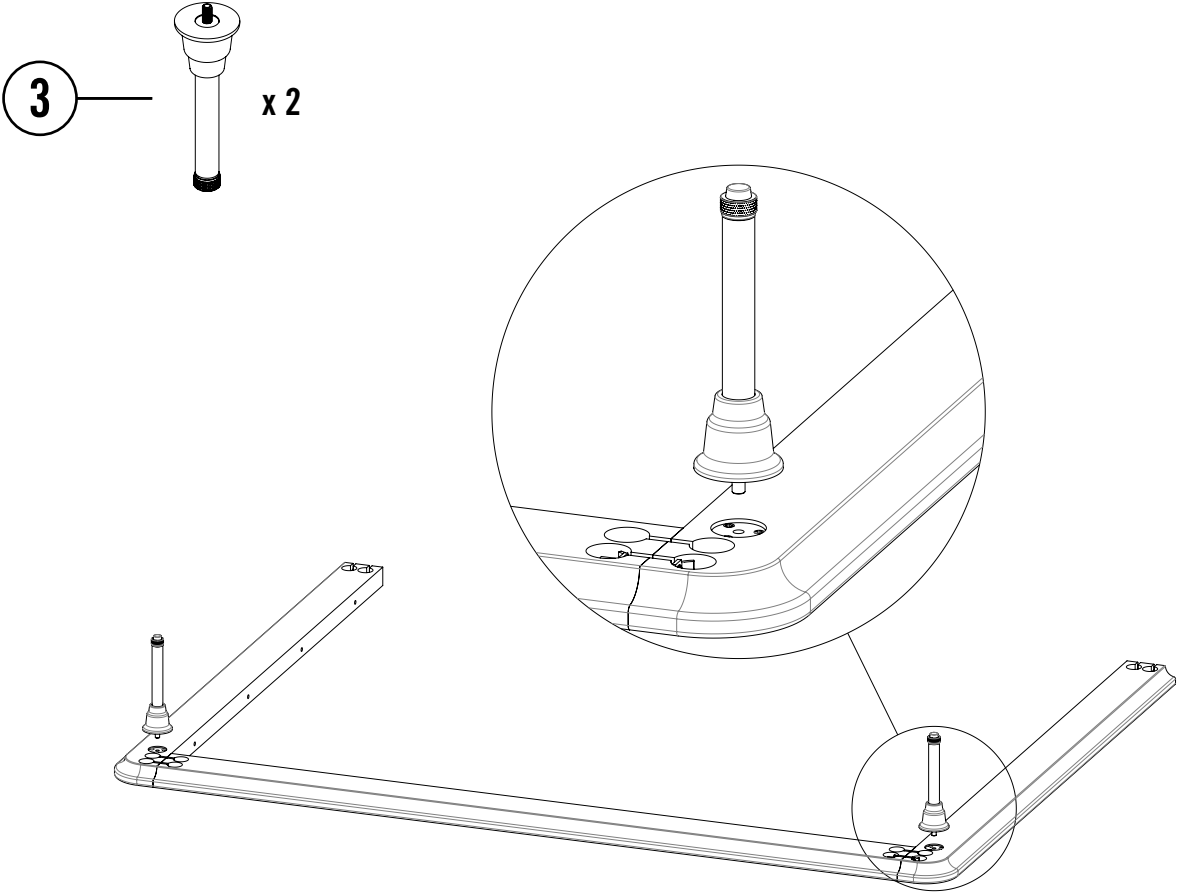

ASSEMBLY STEPS

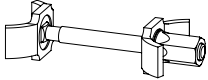
5 —  x 4

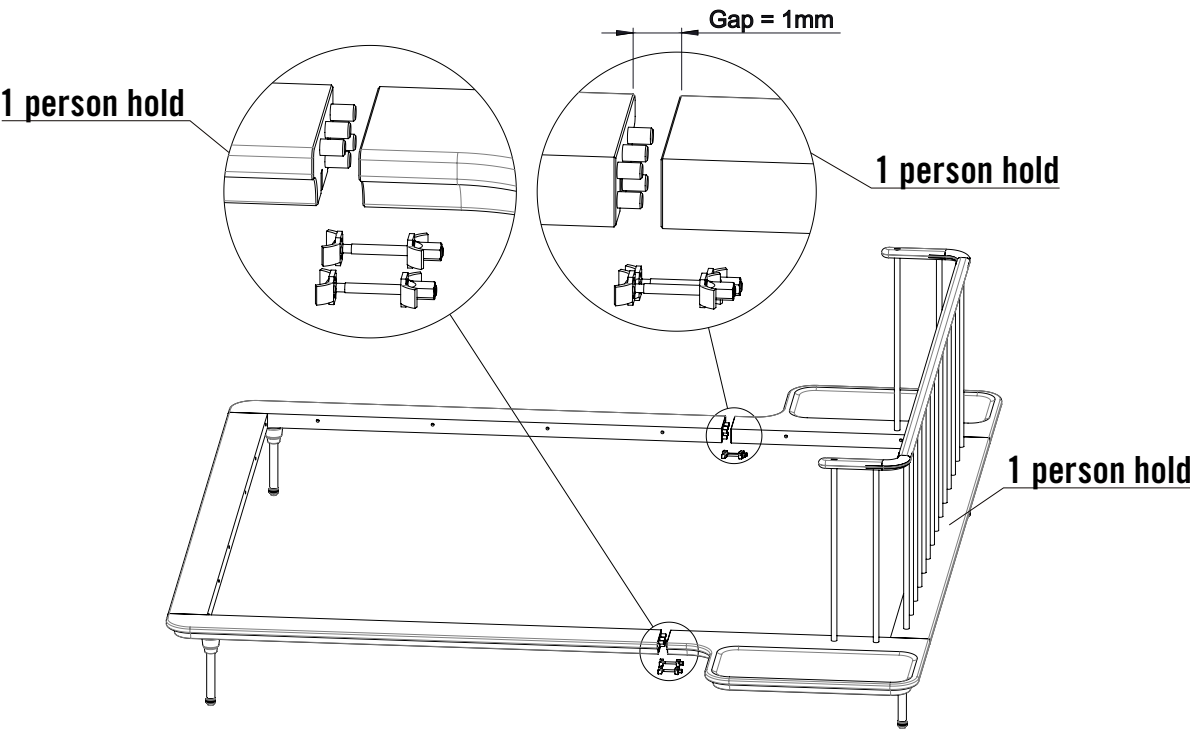

6 —  x 12 (NOTE: ATTACH LOOSE BOLTS)

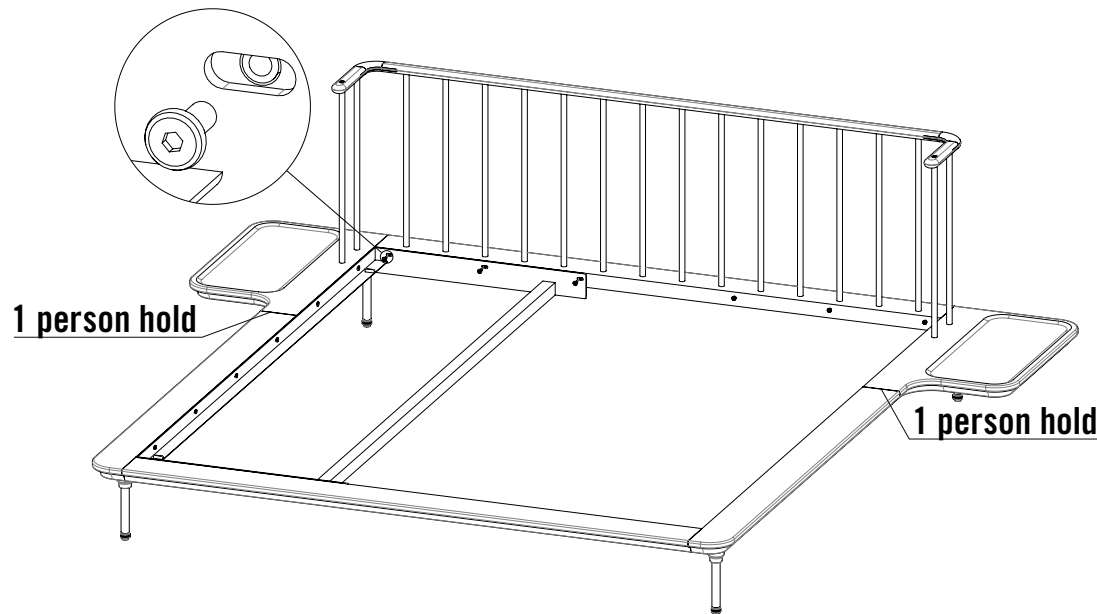

ASSEMBLY STEPS

8 —  x 12 (NOTE: ATTACH LOOSE BOLTS)

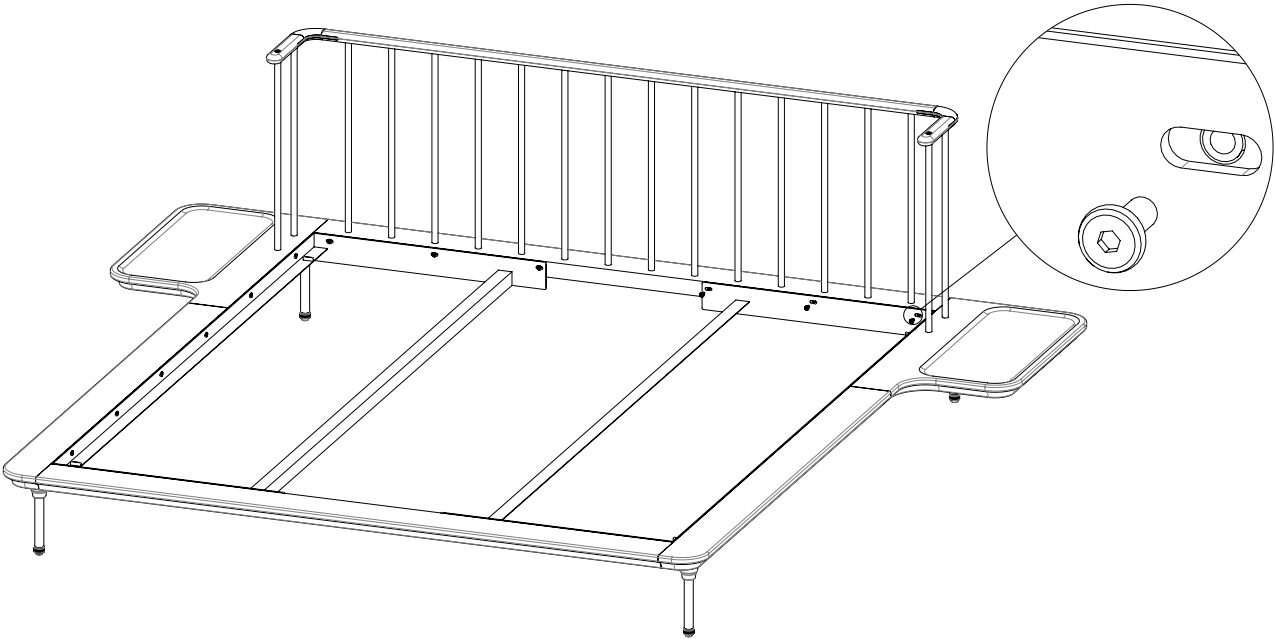

9 — (NOTE: ATTACH TIGHT ALL FROM STEP 5 TO 8)

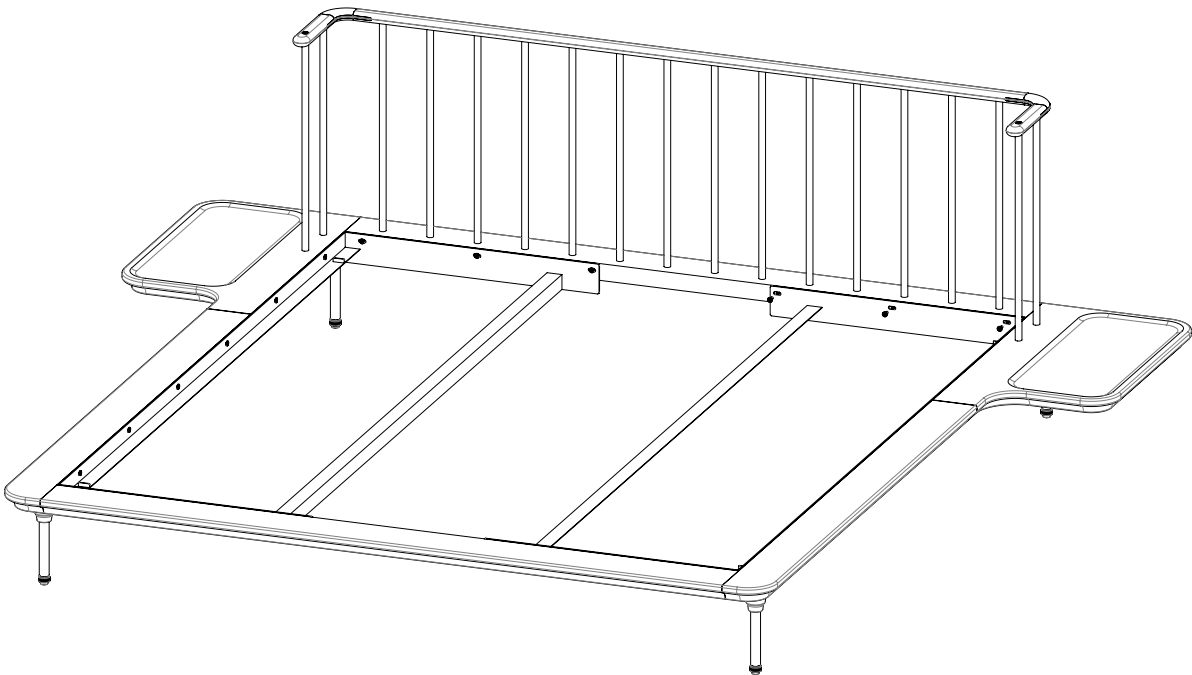

ASSEMBLY STEPS

